

No.1303 Track System



Leveraging more than 120 years of heritage, our No.101 sliding door track systems have been re-engineered for the 21st-century consumer to assure authentic and lasting architectural significance. These commercial quality hardware systems are available in multiple configurations and can accommodate 1-3/8" to 2-1/2" thick doors weighing up to 1000lbs when installed properly. Each system is individually packaged and includes a 1-1/2" diameter track assembly with mounting brackets, No.3 cast iron door hangers and door guide.



An Industrial Brands Company
www.industrialbrands.com

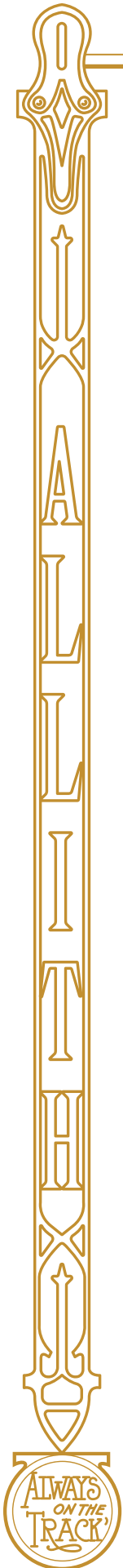

No.1303 Track System

Our No.303 Heavy Door Track Systems can be complex to install, so we recommend using a professional garage door installation company for the best results. All systems are specifically designed to fit the listed openings. For applications where a custom length is required the tracks can easily be cut to the desired length by the installation technician. Optional parts and accessories which coordinate with our No.303 sliding door track systems can be purchased separately.

Available Sizes

<u>item#</u>	<u>Size</u>
314-10-550	No.1303 Allith bi-parting sliding door track system for door openings 78" to 96" wide
314-10-610	No.1303 Allith bi-parting sliding door track system for door openings 96" to 144" wide

Included Parts and Assemblies

No.3 sliding track assembly compatible with 1-1/2" track, door guide.
 No.3 Cast Iron Door hangers for No.3 track, mazimum wieght for (2) rollers is 1000 lbs.
 Mounting hardware kits are based on the wall thickness and and are sold separately.

Optional Accessories

<u>Item#</u>	<u>Color</u>	<u>Description</u>
380-30-121	Satin Black	No.305 Raised Door Pull
380-30-221	Satin Black	No.306 Flush door pull

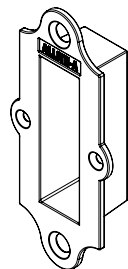
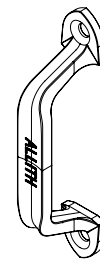

Finishes

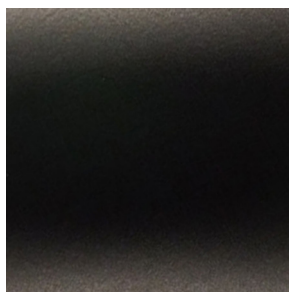

Satin Black Powdercoat

Learn More



General Sales & Inquires

Industrial Brands
 sales@industrialbrands.com
 602.767.4455

Hospitality Sales

Source Direct Imports
 sales@sourcedirectimports.com
 602.956.1149

